

YXL Series High Efficiency Aluminum Frame Three Phase Induction Motors

➤ General Description



- Frame sizes: 63 to 160 Rated output: 0.12 to 18.5kW
- Voltage: 380V Frequency: 50Hz or 60Hz
- Poles: 2, 4, 6, 8 Efficiency levels: IE2
- Duty Cycle: S1 Enclosure: IC411 – TEFC
- Insulation class: F Degree of protection: IP55

Applications: General purpose including cutting machines, pumps, fans, conveyors, machines tools of farm duty and food process.

Features: Beautiful profile, high efficiency and energy saving, class F insulation, IP55 protection grade, low noise, little vibration,

reliable running.

➤ Performance Data

Model	Output kW	FLA	RPM	Eff. %	Power Factor	FLT N.m	380V		50Hz		dB(A)
							$\frac{LRT}{FLT}$ $\frac{I_{st}}{I_N}$	$\frac{LRA}{FLA}$ $\frac{I_{st}}{I_N}$	$\frac{BDT}{FLT}$ $\frac{T_{max}}{T_N}$		
Synchronous speed 3000 r/min											
YXL63M1-2	0.18	0.53	2720	63.9	0.80	0.63	2.2	5.5	2.2	61	
YXL63M2-2	0.25	0.70	2720	67.1	0.81	0.88	2.2	5.5	2.2	61	
YXL71M1-2	0.37	1.0	2740	69.0	0.81	1.29	2.2	6.1	2.2	62	
YXL71M2-2	0.55	1.4	2740	72.3	0.82	1.92	2.2	6.1	2.2	62	
YXL80M1-2	0.75	1.8	2855	77.4	0.82	2.51	2.2	7.0	2.3	62	
YXL80M2-2	1.1	2.5	2870	79.6	0.83	3.66	2.2	7.3	2.3	62	
YXL90S-2	1.5	3.3	2865	81.3	0.84	5.00	2.2	7.6	2.3	67	
YXL90L-2	2.2	4.7	2870	83.2	0.85	7.32	2.2	7.6	2.3	67	
YXL100L-2	3	6.2	2875	84.6	0.87	9.97	2.2	7.8	2.3	74	
YXL112M-2	4	8.0	2910	85.8	0.88	13.1	2.2	8.3	2.3	77	
YXL132S1-2	5.5	10.9	2935	87.0	0.88	17.9	2.0	8.3	2.3	79	
YXL132S2-2	7.5	14.5	2930	88.1	0.89	24.4	2.0	7.9	2.3	79	
YXL160M1-2	11	21.0	2950	89.4	0.89	35.6	2.0	8.1	2.3	81	
YXL160M2-2	15	28.4	2945	90.3	0.89	48.6	2.0	8.1	2.3	81	
YXL160L-2	18.5	34.7	2945	90.9	0.89	60.0	2.0	8.2	2.3	81	

Performance Data

380V 50Hz

Model	Output kW	FLA	RPM	Eff. %	Power Factor	FLT N.m	$\frac{LRT}{FLT} \frac{Tst}{T_N}$	$\frac{LRA}{FLA} \frac{Ist}{I_N}$	$\frac{BDT}{FLT} \frac{Tmax}{T_N}$	dB(A)
Synchronous speed						1500 r/min				
YXL63M1-4	0.12	0.45	1310	55.8	0.72	0.87	2.1	4.4	2.2	52
YXL63M2-4	0.18	0.64	1310	58.6	0.73	1.31	2.1	4.4	2.2	52
YXL71M1-4	0.25	0.81	1330	63.6	0.74	1.80	2.1	5.2	2.2	55
YXL71M2-4	0.37	1.1	1330	65.3	0.75	2.66	2.1	5.2	2.2	55
YXL80M1-4	0.55	1.4	1430	79.0	0.75	3.67	2.3	6.0	2.3	56
YXL80M2-4	0.75	1.9	1425	79.6	0.76	5.03	2.3	6.6	2.3	56
YXL90S-4	1.1	2.7	1420	81.4	0.77	7.40	2.3	6.8	2.3	59
YXL90L-4	1.5	3.5	1420	82.8	0.78	10.1	2.3	7.0	2.3	59
YXL100L1-4	2.2	5.0	1430	84.3	0.80	14.7	2.3	7.6	2.3	64
YXL100L2-4	3	6.6	1430	85.5	0.81	20.0	2.3	7.6	2.3	64
YXL112M-4	4	8.7	1450	86.6	0.81	26.3	2.2	7.8	2.3	65
YXL132S-4	5.5	11.6	1465	87.7	0.82	35.9	2.0	7.9	2.3	71
YXL132M-4	7.5	15.5	1465	88.7	0.83	48.9	2.0	7.5	2.3	71
YXL160M-4	11	22.4	1470	89.8	0.83	71.5	2.0	7.7	2.3	73
YXL160L-4	15	29.9	1470	90.6	0.84	97.4	2.0	7.8	2.3	73
Synchronous speed						1000 r/min				
YXL71M1-6	0.18	0.76	850	54.6	0.66	2.02	1.9	4.0	2.0	52
YXL71M2-6	0.25	0.97	850	57.4	0.68	2.81	1.9	4.0	2.0	52
YXL80M1-6	0.37	1.2	910	67.0	0.70	3.88	1.9	5.5	2.1	54
YXL80M2-6	0.55	1.7	910	70.0	0.71	5.77	1.9	5.5	2.1	54
YXL90S-6	0.75	2.1	935	75.9	0.71	7.66	2.0	6.0	2.1	57
YXL90L-6	1.1	3.0	935	78.1	0.72	11.2	2.0	6.0	2.1	57
YXL100L-6	1.5	4.0	945	79.8	0.72	15.2	2.0	6.5	2.1	61
YXL112M-6	2.2	5.7	965	81.8	0.72	21.8	2.0	6.6	2.1	65
YXL132S-6	3	7.6	975	83.3	0.72	29.4	1.9	6.8	2.1	69
YXL132M1-6	4	9.7	975	84.6	0.74	39.2	1.9	6.8	2.1	69
YXL132M2-6	5.5	13.0	975	86.0	0.75	53.9	1.9	7.0	2.1	69
YXL160M-6	7.5	16.8	975	87.2	0.78	73.5	2.0	7.0	2.1	70
YXL160L-6	11	23.9	975	88.7	0.79	108	2.0	7.2	2.1	70
Synchronous speed						750 r/min				
YXL80M1-8	0.18	0.8	700	52.8	0.61	2.46	1.8	3.3	1.9	52
YXL80M2-8	0.25	1.1	700	57.0	0.61	3.41	1.8	3.3	1.9	52
YXL90S-8	0.37	1.4	695	64.0	0.62	5.08	1.8	4.0	2.0	56
YXL90L-8	0.55	2.0	695	67.5	0.63	7.56	1.8	4.0	2.0	56
YXL100L1-8	0.75	2.3	705	71.5	0.68	10.2	1.8	4.0	2.0	59
YXL100L2-8	1.1	3.3	705	74.5	0.69	14.9	1.8	4.0	2.0	59

Performance Data

380V 50Hz

Model	Output kW	FLA	RPM	Eff. %	Power Factor	FLT N.m	$\frac{LRT}{FLT}$	$\frac{LRA}{FLA}$	$\frac{BDT}{FLT}$	dB(A)
							$\frac{Tst}{T_N}$	$\frac{Ist}{I_N}$	$\frac{Tmax}{T_N}$	
						Synchronous speed		750 r/min		
YXL112M-8	1.5	4.4	715	75.4	0.69	20.0	1.8	4.0	2.0	61
YXL132S-8	2.2	6.0	730	78.2	0.71	28.8	1.8	5.5	2.2	64
YXL132M-8	3	7.7	730	80.6	0.73	39.2	1.8	5.5	2.2	64
YXL160M1-8	4	10.1	725	82.7	0.73	52.7	1.9	6.0	2.2	68
YXL160M2-8	5.5	13.4	725	84.3	0.74	72.4	1.9	6.0	2.2	68
YXL160L-8	7.5	17.7	730	85.8	0.75	98.1	1.9	6.0	2.2	68

Dimensions & Mounting

mm

B14 (Footless and Small Flange Mounted)

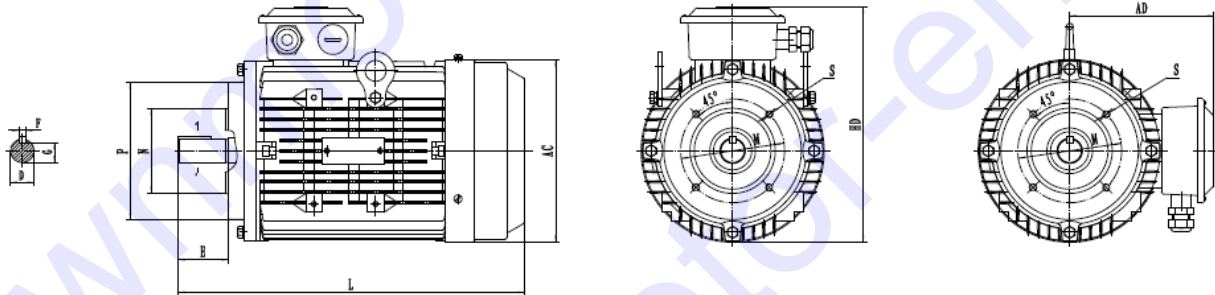

Frame	Poles	Mounting Dimension										Overall Dimension		
		D	E	F	G	M	N	P	R	S	T	AC	AD	L
63M	2,4	11	23	4	8.5	75	60	90	0	4-M5	2.5	135	112	225
71M	2,4,6	14	30	5	11	85	70	105	0	4-M6	2.5	145	120	245
80M	2,4,6,8	19	40	6	15.5	100	80	120	0	4-M6	3	165	135	295
90S	2,4,6,8	24	50	8	20	115	95	140	0	4-M8	3	180	145	320
90L	2,4,6,8													345
100L	2,4,6,8	28	60	8	24	130	110	160	0	4-M8	3.5	205	155	390
112M	2,4,6,8	28	60	8	24	130	110	160	0	4-M8	3.5	225	180	420

B34 (Foot and Small Flange Mounted)

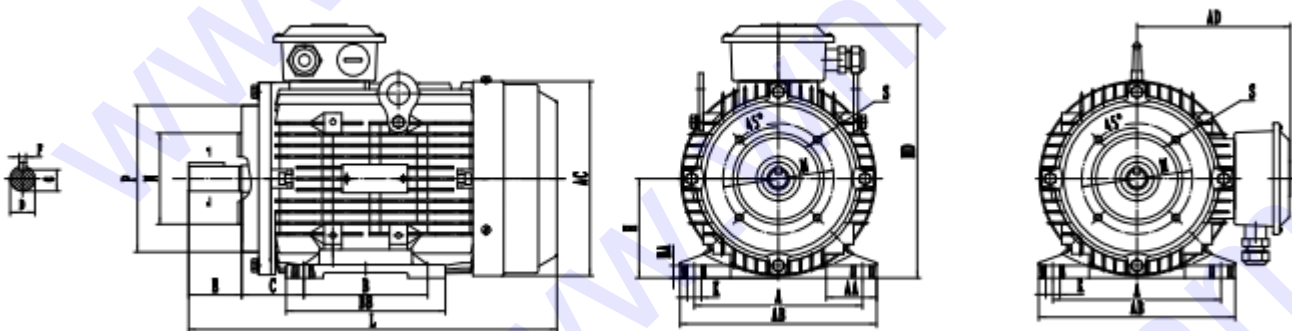

Frame	Poles	Mounting Dimension															Overall Dimension							
		A	B	C	D	E	F	G	H	K	M	N	P	R	S	T	AA	BB	HA	AB	AC	AD	HD	L
63M	2,4	100	80	40	11	23	4	8.5	63	7X11.5	75	60	90	0	4-M5	2.5	35.5	110	8	125	135	112	175	225
71M	2,4,6	112	90	45	14	30	5	11	71	7X11.5	85	70	105	0	4-M6	2.5	36	120	8	136	145	120	190	245
80M	2,4,6,8	125	100	50	19	40	6	15.5	80	10X13	100	80	120	0	4-M6	3	35	135	10	160	165	135	215	295
90S	2,4,6,8	140	100	56	24	50	8	20	90	10X13	115	95	140	0	4-M8	3	35	145	12	175	180	145	235	320
90L	2,4,6,8		125															170						345
100L	2,4,6,8	160	140	63	28	60	8	24	100	12X16	130	110	160	0	4-M8	3.5	37	186	14	196	205	155	255	390
112M	2,4,6,8	190	140	70	28	60	8	24	112	12X16	130	110	160	0	4-M8	3.5	44	200	14	226	225	180	290	420

B3 (Horizontal Foot Mounted Only)

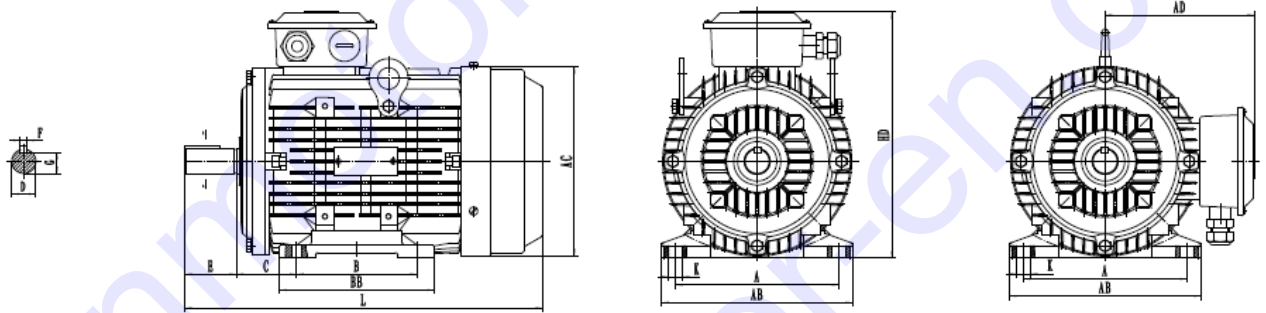

Frame	Poles	Mounting Dimension															Overall Dimension				
		A	B	C	D	E	F	G	H	K	BB	HA	AB	HD	L						
63M	2,4	100	80	40	11	23	4	8.5	63	7X11.5	105	8	125	175	225						
71M	2,4,6	112	90	45	14	30	5	11	71	7X11.5	116	8	136	190	245						
80M	2,4,6,8	125	100	50	19	40	6	15.5	80	10X13	130	10	160	215	295						
90S	2,4,6,8	140	100	56	24	50	8	20	90	10X13	130	12	175	235	320						
90L			125								155				345						
100L	2,4,6,8	160	140	63	28	60	8	24	100	12X16	176	14	196	255	390						
112M	2,4,6,8	190	140	70	28	60	8	24	112	12X16	180	14	226	290	420						
132S	2,4,6,8	216	140	89	38	80	10	33	132	12X16	186	16	260	335	465						
132M			178								224				505						
160M	2,4,6,8	254	210	108	42	110	12	37	160	15X19	260	20	309	400	605						
160L			254								304				650						

B5 (Footless and B5 Flange Mounted)

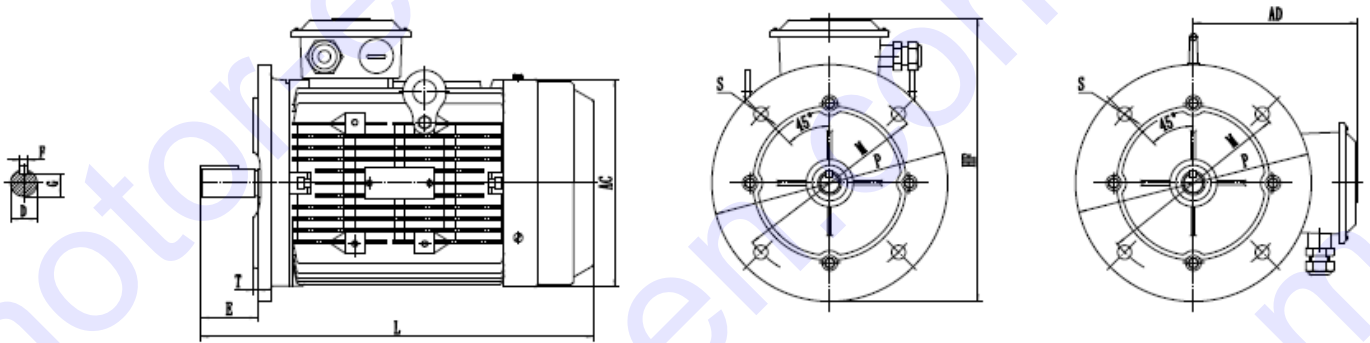

Frame	Poles	Mounting Dimension										Overall Dimension			
		D	E	F	G	M	N	P	R	S	T	AC	AD	HF	L
63M	2,4	11	23	4	8.5	115	95	140	0	4-Φ10	3	135	112	140	225
71M	2,4,6	14	30	5	11	130	110	160	0	4-Φ10	3.5	145	120	160	245
80M	2,4,6,8	19	40	6	15.5	165	130	200	0	4-Φ12	3.5	165	135	245	295
90S	2,4,6,8	24	50	8	20	165	130	200	0	4-Φ12	3.5	180	145	265	320
90L															345
100L	2,4,6,8	28	60	8	24	215	180	250	0	4-Φ15	4	205	155	300	390
112M	2,4,6,8	28	60	8	24	215	180	250	0	4-Φ15	4	225	180	315	420
132S	2,4,6,8	38	80	10	33	265	230	300	0	4-Φ15	4	270	205	370	465
132M															505
160M	2,4,6,8	42	110	12	37	300	250	350	0	4-Φ19	5	320	240	435	605
160L															650

B35 (Foot and B5 Flange Mounted)

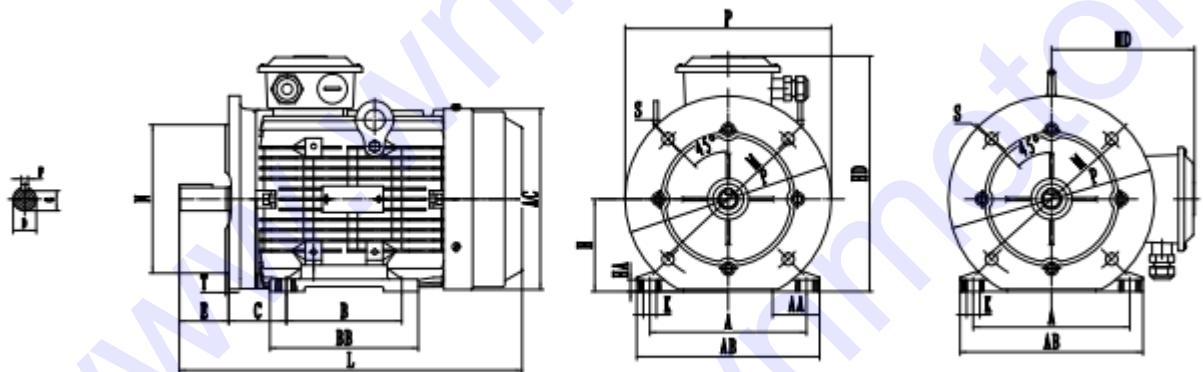

Frame	Poles	Mounting Dimension													Overall Dimension									
		A	B	C	D	E	F	G	H	K	M	N	P	R	S	T	AA	BB	HA	AB	AC	AD	HD	L
63M	2,4	100	80	40	11	23	4	8.5	63	7X11.5	115	95	140	0	4-Φ10	3	35.5	105	8	125	135	112	175	225

71M	2,4,6	112	90	45	14	30	5	11	71	7X11.5	130	110	160	0	4-Φ10	3.5	36	116	8	136	145	120	190	245
80M	2,4,6,8	125	100	50	19	40	6	15.5	80	10X13	165	130	200	0	4-Φ12	3.5	35	130	10	160	165	135	215	295
90S	2,4,6,8	140	100	56	24	50	8	20	90	10X13	165	130	200	0	4-Φ12	3.5	35	130	12	175	180	145	235	320
90L			125															155						345
100L	2,4,6,8	160	140	63	28	60	8	24	100	12X16	215	180	250	0	4-Φ15	4	37	176	14	196	205	155	255	390
112M	2,4,6,8	190	140	70	28	60	8	24	112	12X16	215	180	250	0	4-Φ15	4	44	180	14	226	225	180	290	420
132S	2,4,6,8	216	140	89	38	80	10	33	132	12X16	265	230	300	0	4-Φ15	4	45	186	16	260	270	205	335	465
132M			178															224						505
160M	2,4,6,8	254	210	108	42	110	12	37	160	15X19	300	250	350	0	4-Φ19	5	62	260	20	309	320	240	400	605
160L			254															304						650

Data above may be changed without prior notice.